



RUDEX AUSTRALIA
RUBBER & CONVEYOR SOLUTIONS

RUDEX AUSTRALIA
Industrial Hose Product Portfolio



RUDEX AUSTRALIA

RUBBER & CONVEYOR SOLUTIONS

RUDEX - GREENLINE MINING HOSE

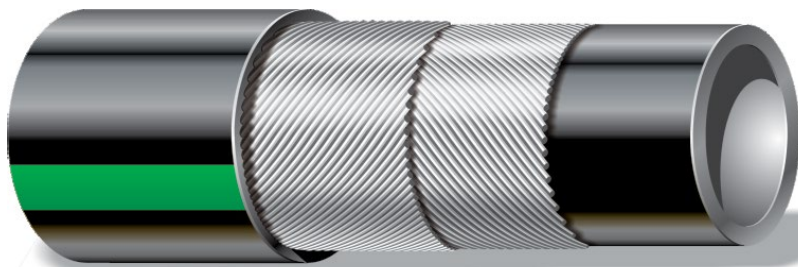

Recommended for	Mining and industrial air and water pressure applications. This range meets the requirements of L.D SABS 988 Specifications up to and including 12,5mm ID to 100mm ID size and have a 3:1 built in safety factor. Available in Smooth and Wrapped Cover.
Construction Liner	NR/SBR compound.
Reinforcement	High strength synthetic yarn spirally applied.
Working Pressure:	10 bar.
Cover	NR/ SBR compound , Weather and abrasion resistant with a green colour identification.
Temperature range	-20° C to + 80°C
Hose ends	Plain.
Lengths	All ID's 30m

TECHNICAL DATA

HOSE ID (mm)		APPROX OD (mm)	RATED WP (bar)	SUCTION (-bar)	APPROX LINEAR DENSITY (mm)
NOM	ACT				
10	9.5	17.5	10.0	N/A	0.24
12	12.7	21.7	10.0	N/A	0.35
16	15.9	25.3	10.0	N/A	0.43
20	19.1	28.1	10.0	N/A	0.49
25	25.4	35.2	10.0	N/A	0.68
32	31.8	43.8	10.0	N/A	0.85
40	38.1	49.5	10.0	N/A	0.99
45	44.1	55.7	10.0	N/A	1.14
50	50.8	62.7	7.0	N/A	1.38
63	63.5	75.8	7.0	N/A	1.69
75	76.2	88.1	7.0	N/A	2.00
100	101.6	113.1	7.0	N/A	2.62



RUDEX AUSTRALIA

RUBBER & CONVEYOR SOLUTIONS

RUDEX - GOLDLINE MINING HOSE

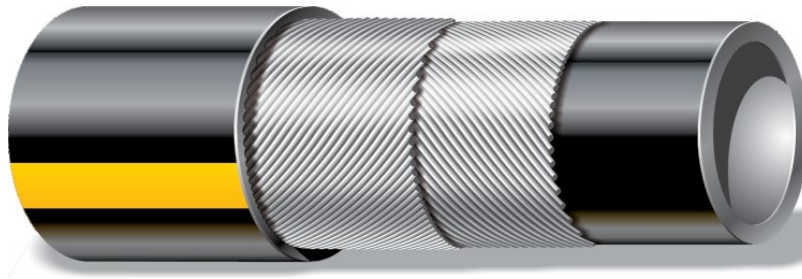

Recommended for	Air and water pressure applications where maximum resistance to arduous service conditions. This range meets the requirements of H.D SABS 988 Specifications up to and including 12,5mm ID to 100mm ID size and have a 3:1 built in safety factor. This hose is widely accepted as an outstanding heavy duty mining and industrial hose. Available in Smooth and Wrapped Cover .
Construction Liner	NR/SBR compound.
Reinforcement	High strength synthetic yarn spirally applied.
Working Pressure:	20 bar
Cover	NR/ SBR compound , Weather and abrasion resistant with a gold colour identification.
Temperature range	-20° C to + 80°C
Hose ends	Plain.
Lengths	All ID's 30m

TECHNICAL DATA

HOSE ID (mm)		APPROX OD (mm)	RATED WP (bar)	SUCTION (-bar)
NOM	ACT			
12	12.7	23.1	20.0	N/A
20	19.1	29.5	20.0	N/A
25	25.4	36.8	20.0	N/A
32	31.8	49.5	20.0	N/A
40	38.1	54.3	20.0	N/A
50	50.8	66.7	20.0	N/A
63	63.5	79.8	20.0	N/A
75	76.2	92.1	20.0	N/A
100	101.6	117.1	20.0	N/A
100	101.6	123.6	20.0	N/A



RUDEX AUSTRALIA

RUBBER & CONVEYOR SOLUTIONS

RUDEX - HD SAND AND SHOTBLAST HOSE

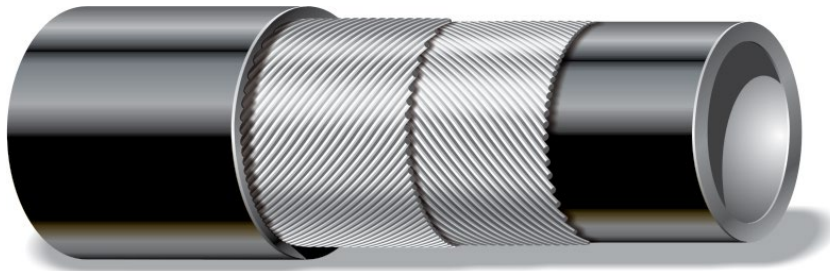

Recommended for	Heavy duty sand and shot blast applications, where extremely robust but flexible hose is required. This range meets the requirements of SABS 988 specifications up to and including 25mm ID to 50mm ID size and have a 3:1 built in safety factor. Available in Wrapped Cover only.
Construction Liner	SBR, Abrasion resistant compound.
Reinforcement	Multiple plies of synthetic textile fabric.
Working Pressure:	12 bar.
Cover	NR/SBR compound. Weather and abrasion resistant.
Temperature range	-20° C to + 80°C
Hose ends	Plain.
Lengths	All ID's 30m

TECHNICAL DATA

HOSE ID (mm)		APPROX OD (mm)	RATED WP (bar)	SUCTION (-bar)	APPROX LINEAR DENSITY (mm)
NOM	ACT				
20	19.1	37.1	12.0	N/A	0.97
25	25.4	44.0	12.0	N/A	1.50
32	31.8	54.0	12.0	N/A	1.89
40	38.1	65.0	12.0	N/A	2.80
50	50.8	78.0	12.0	N/A	3.58
63	63.5	87.0	12.0	N/A	3.58
75	76.2	96.0	12.0	N/A	3.58



RUDEX AUSTRALIA

RUBBER & CONVEYOR SOLUTIONS

RUDEX - OIL RESISTANT MINING HOSE

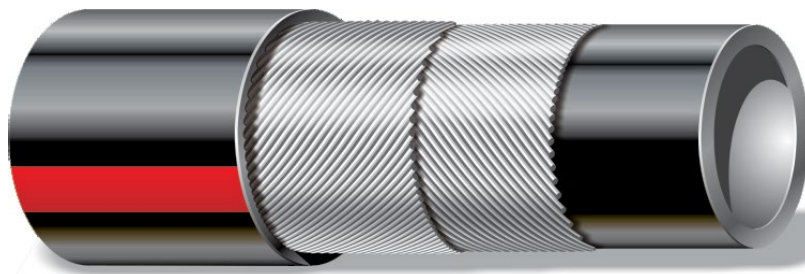

Recommended for	Air and Water pressure applications where resistance to heat, oil and oily vapors are required. Especially suitable for heavy duty air line, oil lubricated, pneumatic tools. This range meets the requirements of L.D. SABS 988 specifications up to and including 12,5mm ID to 100mm ID size and have a 3:1 built in safety factor. Available in Wrapped Cover only.
Construction Liner	NBR compound.
Reinforcement	High tensile synthetic yarn, spirally applied red coloured identification stripe.
Working Pressure:	10 bar
Cover	NR/SBR compound. Weather and abrasion resistant with a red coloured identification stripe.
Temperature range	-20° C to + 80°C
Hose ends	Plain.
Lengths	All ID's 30m

TECHNICAL DATA

HOSE ID (mm)		APPROX OD (mm)	RATED WP (bar)	SUCTION (-bar)	APPROX LINEAR DENSITY (mm)
NOM	ACT				
12	12.7	21.7	10.0	N/A	0.42
16	15.9	25.3	10.0	N/A	0.53
20	19.1	29.1	10.0	N/A	0.59
25	25.4	35.2	10.0	N/A	0.81
32	31.8	51.1	10.0	N/A	1.51
40	38.1	56.8	10.0	N/A	1.67
50	50.8	70.4	10.0	N/A	1.70
63	63.5	86.3	10.0	N/A	3.23
75	76.2	98.6	10.0	N/A	3.80
100	101.6	123.6	10.0	N/A	4.90



RUDEX AUSTRALIA

RUBBER & CONVEYOR SOLUTIONS

RUDEX -BLUE OXYGEN WELDING HOSE

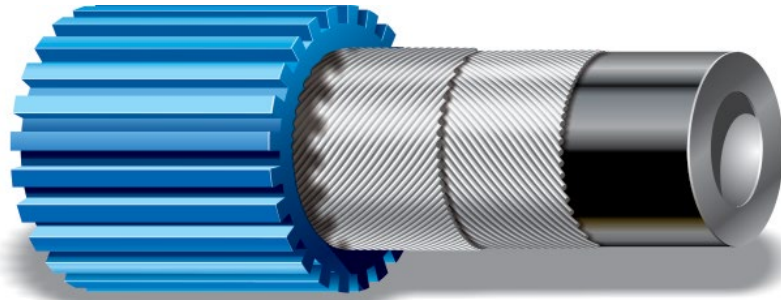

Recommended for	All welding and cutting applications requiring light flexible hose conforming to SABS specification 582. These hoses exhibit high flame retardant and abrasion resistant covers, which resist cracking as a result of repeated flexing.
Construction Liner	NR/SBR , Ignition resistant compound.
Reinforcement	Spiral plies of synthetic yarn.
Working Pressure:	20 bar
Cover	SNR/SBR compound. Weather and abrasion resistant. Coloured for gas identification: Blue for Oxygen.
Temperature range	-20° C to + 80°C
Hose ends	Plain.
Lengths	30m, 50m and 100m

TECHNICAL DATA

HOSE ID (mm)		APPROX OD (mm)	LENGTH (m)	RATED WP (-bar)	APPROX LINEAR DENSITY (mm)
NOM	ACT				
8	7.9	16.0	30	20.0	0.20
8	7.9	16.0	50	20.0	0.20
8	7.9	16.0	100	20.0	0.20



RUDEX AUSTRALIA

RUBBER & CONVEYOR SOLUTIONS

RUDEX - RED ACETYLENE WELDING HOSE

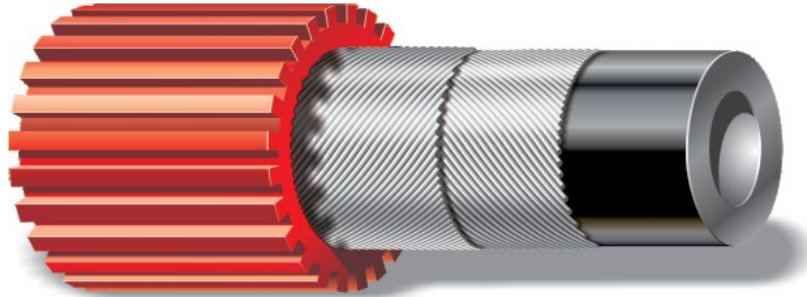

Recommended for	All welding and cutting applications requiring light flexible hose conforming to SABS specification 582. These hoses exhibit high flame retardant and abrasion resistant covers, which resist cracking as a result of repeated flexing.
Construction Liner	NR/SBR , Ignition resistant compound.
Reinforcement	Spiral plies of synthetic yarn.
Working Pressure:	20 bar
Cover	SNR/SBR compound. Weather and abrasion resistant. Coloured for gas identification: Red for Acetylene.
Temperature range	-20° C to + 80°C
Hose ends	Plain.
Lengths	30m, 50m and 100m

TECHNICAL DATA

HOSE ID (mm)		APPROX OD (mm)	LENGTH (m)	RATED WP (-bar)	APPROX LINEAR DENSITY (mm)
NOM	ACT				
8	7.9	16.0	30	20.0	0.20
8	7.9	16.0	50	20.0	0.20
8	7.9	16.0	100	20.0	0.20



RUDEX AUSTRALIA

RUBBER & CONVEYOR SOLUTIONS

RUDEX –LPG DOMESTIC GAS HOSE

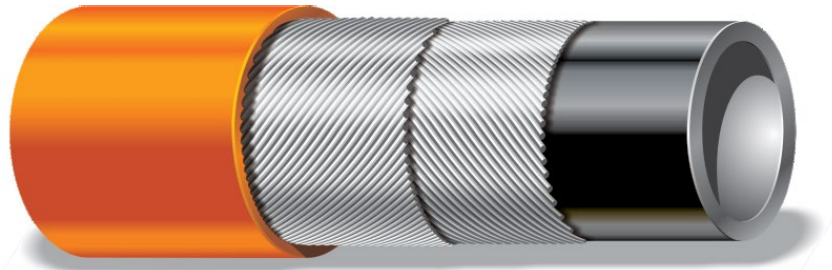

Recommended for	Recommended for hose connection between LP gas storage cylinders and domestic appliances, and extra heavy duty industrial pneumatic tools requiring the hose to be resistant to lubrication mist and oils. This hose conforms to SABS specification 582.
Construction Liner	NR/SBR compound. LP gas resistant.
Reinforcement	Spiral plies of synthetic yarn.
Working Pressure:	20 bar
Cover	PVC/NR orange compound,. Oil , weather and abrasion resistant, Orange for gas identification.
Temperature range	-20° C to + 80°C
Hose ends	Plain.
Lengths	30m,50m and 100m

TECHNICAL DATA

HOSE ID (mm)		APPROX OD (mm)	RATED WP (bar)	SUCTION (-bar)	APPROX LINEAR DENSITY (mm)
NOM	ACT				
8	8.3	16.2	12.0	N/A	0.24



RUDEX AUSTRALIA

RUBBER & CONVEYOR SOLUTIONS

RUDEX –HARDWALL MATERIALS HANDLING HOSE



Recommended for	<p>Hardwall Materials Handling Hose are used for slurry handling in the mineral processing industry, coal refinement plants, power plants in the steel and cement industries and other applications where high wear resistance combined with flexibility and vibration reduction is required.</p> <p>High tensile reinforcement cord with embedded galvanized steel wire helix are used to ensure and meet pressure and vacuum requirements. These hoses can be supplied with or without built in flanges as we offer loose aluminium split flanges to suit.</p>
Construction Liner	Lined in Rudex RI038 , Rudex RI038 indicator RED/ YELLOW and in Thicknesses from 3mm to 30mm.
Hose ends	Spiral plies of synthetic yarn.
Lengths	All Id's — Lengths available on request up to 20m from 50mm ID to 100mm ID and Lengths available up to 10m from 125mm ID to 900mm ID.



TECHNICAL DATA

PRODUCT DESCRIPTION

Material type	Hard wall materials handling hose
POLYMER Inner Liner	Nr / sbr compound.
LINER COLOUR	RED , BLACK, WHITE or YELLOW.
LINER THICKNESS	From 3mm up to 30mm thickness.
SHORE HARDNESS	35 – 70 Shore a hardness.
CHARACTERISTICS	Standard and super abrasion resistant.

CONSTRUCTION

COVER POLYMER	Black nr/sbr rubber.
SHORE A HARDNESS	55-65 Shore.
CHARACTERISTICS	Nr / sbr compound, weather and ozone resistant.
MULTIPLE LAYERS OF REINFORCEMENT	Multiple layers of high strength synthetic textile cord or multiple plies of synthetic fabrics.
WIRE HELIX	Galvanized wire.
MANUFACTURING DEPARTMENT	Hand built hose.
INNER DIAMETER	Available from 50mm ID up to 900mm ID.
LENGTHS	Available from 1m and 20m lengths.
WORKING PRESSURE	Available from 700 kpa to 2000kpa
BURST PRESSURE	Offered up to 4:1 safety factor.
RECOMMENDED TEMPERATURE	-20°C to + 80°C

FITTINGS:

Available with built in flanges to suit customer's requirements or plain ended to suit aluminium split flanges.



RUDEX AUSTRALIA

RUBBER & CONVEYOR SOLUTIONS

RUDEX –SOFTWALL MATERIALS HANDLING HOSE



Recommended for	Softwall Materials Handling Hose are used for slurry handling in the mineral processing industry, coal refinement plants, power plants in the steel and cement industries and other applications where high wear resistance combined with flexibility and vibration reduction is required. High tensile reinforcement cord ensure and meet pressure and delivery requirements. These hoses can be supplied with or without built in flanges to suit.
Construction Liner	Can be available in RED, BLACK, WHITE or YELLOW and in Thicknesses from 3mm to 30mm.
Hose ends	Plain Ended or with Built in Flanges
Lengths	All ID's - Lengths available on request up to 20m from 50mm ID to 150mm ID and Lengths available up to 15m from 175mm id to 900mm ID



RUDEX AUSTRALIA

RUBBER & CONVEYOR SOLUTIONS

TECHNICAL DATA

PRODUCT DESCRIPTION

MATERIAL TYPE	Soft wall materials handling hose.
POLYMER Inner Liner	Nr / sbr compound.
LINER COLOUR	RED , BLACK, WHITE or YELLOW.
LINER THICKNESS	From 3mm up to 30mm thickness.
SHORE HARDNESS	35 – 70 Shore a hardness.
CHARACTERISTICS	Standard and super abrasion resistant.

CONSTRUCTION

COVER POLYMER	Black nr/sbr rubber.
SHORE A HARDNESS	55-65 Shore.
CHARACTERISTICS	Nr / sbr compound, weather and ozone resistant.
MULTIPLE LAYERS OF REINFORCEMENT	Multiple layers of high strength synthetic textile cord or multiple plies of synthetic fabrics.
MANUFACTURING DEPARTMENT	Hand built hose.
INNER DIAMETER	Available from 50mm ID up to 900mm ID
LENGTHS	Available from 1m and 20m lengths.
WORKING PRESSURE	Available from 700kpa to 2000kpa.
BURST PRESSURE	Offered up to 4:1 safety factor.
RECOMMENDED TEMPERATURE	-20°C to + 80°C
FITTINGS:	Available with built in flanges to suit customer's requirements or plain ended.



RUDEX – MATERIALS HANDLING RUBBER HOSE BENDS



Recommended for	Mining and Industrial applications where preformed hose is required. Product can be supplied with a thickened inner liner on the outer arc, if required.
Construction Liner	NR/SBR compound. Water, air and mild acid resistance or abrasion resisting.
Reinforcement	High tensile wire helix embedded between multiple plies of woven fabric.
Cover	NR/SBR compound Water , air and mild acid resistance o r abrasion resisting.
Temperature range	-20°C– to + 80°C
Hose ends	Built in “universal “ flanged coupling on bead supported HD 890 flanges.
Radius	Lengths —to be confirmed with enquiry.

NOTES

- » For available hose ID's and bend radii available, refer to schedule of formers
- » The terms “Extra Liner on Outer Arc” is used in describing a bend built with a heavy duty liner and an additional thickness of liner material which is applied only to the outside arc of a bend, so that the thickness of liner on the outside arc is double that on the inside arc.
- » Short radius bends CANNOT be supplied less than 90°
- » Provided that a tolerance of +/- 5° is allowed on the angle, other bends CAN be supplied for any angles as shown on the tables that follow.
- » The Centre to face distance on any bend produced from the above formers can be calculated from:

Centre to face = R tan X, where X = ½ bend angle

R = Radius of bend

e.g, Centre to Face of a 45° Bend on Formers P3.

Example of Centre to Face Calculation

R = Radius of P3 = 650mm

A = Centre to Face

X = ½ Bend angle = 22° 30' tan ½ bend angle from tables = 0.4142

Centre to Face = 650 x 0.4142

Centre to Face = 269mm

NB: In a 90° bend the radius and Centre to Face are the same dimensionally



RUDEX AUSTRALIA
RUBBER & CONVEYOR SOLUTIONS

TECHNICAL DATA

PRODUCT DESCRIPTION

MATERIAL TYPE	Materials handling rubber hose bends.
POLYMER Inner Liner	Nr / sbr compound.
LINER COLOUR	RED , BLACK, WHITE or YELLOW.
LINER THICKNESS	From 3mm up to 30mm thickness.
SHORE HARDNESS	35 – 70 Shore a hardness.
CHARACTERISTICS	Standard and super abrasion resistant.

CONSTRUCTION

COVER POLYMER	Black nr/sbr rubber.
SHORE A HARDNESS	55-65 Shore.
CHARACTERISTICS	Nr / sbr compound, weather and ozone resistant.
MULTIPLE LAYERS OF REINFORCEMENT	Multiple layers of high strength synthetic textile cord or multiple plies of synthetic fabrics.
MANUFACTURING DEPARTMENT	Hand built hose.
INNER DIAMETER	Available from 50mm ID up to 900mm ID.
Degrees	Available from 30 deg to 90 deg.
WORKING PRESSURE	Available from 700kpa to 2000kpa.
BURST PRESSURE	Offered up to 4:1 safety factor.
RECOMMENDED TEMPERATURE	-20°C to + 80°C
FITTINGS:	Available with built in flanges to suit customer's requirements or plain ended.



HOSE BENDS SCHEDULE OF FORMERS

BEND ID (mm)		FORMER REF	RADIUS (mm)	LINER THICKNESS (mm)	RANGE OF ANGLES
NOM	ACT				
75	76.2	E	294	9	45°-90°
100	102	G2	340	9	30°-90°
100	102	G3	610	9	20°-90°
114	114	H1	610	9	90°
114	114	H2	400	9	45°
125	127	J1	203	9	90° only
125	127	J2	381	9	30°-90°
125	127	J4	889	9	30°-90°
140	140	K2	762	9	30°-90°
150	153	L2	306	9	45°-90°
150	153	L3	490	9	30°-90°
150	153	L4	533	9	30°-90°
150	153	L5	584	9	30°-85°
150	153	L7	762	9	30°-90°
200	203	P1	229	9	90° only
200	203	P2	457	9	30°-90°
200	203	P3	650	9	30°-90°
200	203	P4	800	9	90°
200	203	P5	1200	9	30°-90°
250	254	S1	610	9	30°-90°
250	254	S2	1000	9	25°-90°
250	254	S3	640	9	20°-60°
300	305	T1	521	9	30°-90°
300	305	T2	556	9	30°-90°
300	305	T3	1300	9	30°-90°



RUDEX AUSTRALIA

RUBBER & CONVEYOR SOLUTIONS

RUDEX – MATERIALS HANDLING RUBBER HOOPED DREDGE HOSE



Recommended for	Hardwall Materials Handling Rubber Hooped Dredge Hose are used as an essential component of dredging ,suction dredging hose plays a very important role with the cutter suction dredge or large trailing suction hopper dredge. The hoses are available in sizes ranging from 6” - 32” and lengths up to 10m.
Construction Liner	NR/SBR Compound available in RED,BLACK WHITE or YELLOW and in Thicknesses from 3mm to 30mm thickness.
Reinforcement	Multiple layers of high tensile strength fiber, spiral galvanised steel wire and hoops reinforcement.
Cover	Black EPDM/SBR Compound.
Temperature range	-20°C– to + 80°C
Hose ends	With Built in Flanges.
Lengths	All Id’s - Lengths available on request up to 20m from 50mm ID to 150mm ID and Lengths available up to 15m from 175mm id to 900mm ID.

NOTES

These are available in Softwall Construction. This is designed only based on request.



RUDEX – ALUMINIUM SPLIT FLANGE COUPLINGS

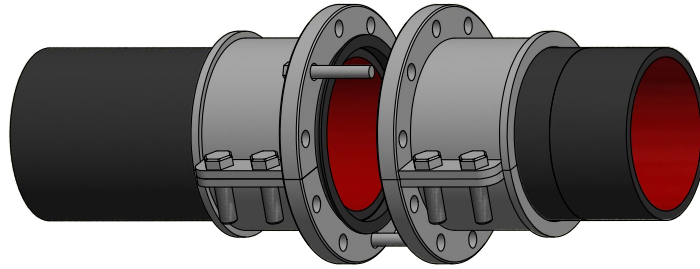

Recommended for

Aluminium Split Flange Couplings are designed for use with hoses, bends and rubber lined steel pipes for slurry handling in heavy wear applications. The re-usable aluminium couplings ensure easy and fast on site assembly.

Aluminium split flange couplings consist of 2 and 4 piece high strength aluminium alloys.

These are mounted mechanically on corrugated or smooth cover hoses.

Aluminium split flange couplings comply with DIN and ANSI flange standards.



QUESTIONNAIRE – MATERIALS HANDLING HOSE SYSTEMS

Customer:	Contact person:
Phone:	Fax:
Address:	Country (representation):
	E-Mail:

1) Process

Hydraulic transport Pneumatic transport Transport by gravitation

Medium/material:

Specific weight: g/cm³

Chemicals:

Concentration: Temperature:

Particle size of solid material:

Flow rate: m³/s

Velocity: m/s

2) Materials handling hose

Inner diameter: mm Length: m

Qty elbows/bends (please attach piping diagram):

Flange/coupling: Type: Material:

Flange holes according to standard:

Bolt circle: mm

Outer diameter: mm

Bolt holes: No.

PCD required: mm

Operating pressure:

Pressure Suction Pressure and suction

Working pressure: MPa Vacuum: MPa

Permanent temperature: °C Maximum temperature: °C/ min

Minimal bending radius: mm

3) Customer preferences

Problems:

Additional information:

Drawing attached:

Yes For retention For returning

Date

Customer Name

Signature



Your local contact



RUDEX AUSTRALIA
RUBBER & CONVEYOR SOLUTIONS

RUDEX AUSTRALIA
20 Palmer Crescent Davenport, WA 6230
Mobile: 0459966284
Email: darryl@rudexaustralia.com.au